

Control4[®] Lux Faceplate Installation Guide

For the latest version of this guide and to view additional materials, open the URL below or scan the QR code. Your device must be able to view PDFs.

LATEST VERSION OF THIS GUIDE



CONTROL4 LUX QUICK START



CONTROL4 LUX WIRING GUIDE



Supported models

C4-L-FP1
C4-L-FP2
C4-L-FP3
C4-L-FP4

Introduction

Control4[®] Lux Faceplates are easy to install and boast a premium look. The included mounting plate provides a solid grounding point and allows the faceplate to magnetically snap into place. Faceplates are available in 1-, 2-, 3-, and 4-gang configurations.

Box contents

- Control4 Lux Faceplate
- Control4 Lux Mounting plate
- Mounting plate hardware
- Extra hardware for the mounting plate and device
- Warranty card
- *Control4 Lux Faceplate Installation Guide* (this document)

Installation instructions



WARNING! Turn OFF electrical power before installing or servicing this product. Improper use or installation can cause SERIOUS INJURY, DEATH or LOSS/DAMAGE OF PROPERTY.

ATTENTION! Coupez l'alimentation électrique avant d'installer ou de réparer ce produit. Une mauvaise installation ou utilisation peut entraîner des blessures graves, décès ou perte / dommages à la propriété.

- 1 Separate the magnetic faceplate from the mounting plate.
- 2 Using a **manual screwdriver**, loosely fasten the mounting plate to the wall box using the supplied hardware. Level the mounting plate, then tighten the mounting plate hardware using a manual screwdriver. Pull the rest of the wires through the mounting plate.



NOTE: Avoid overtightening the mounting plate screws. Tighten the screws enough that the mounting plate is snug against the wall or wall box, but not bent.

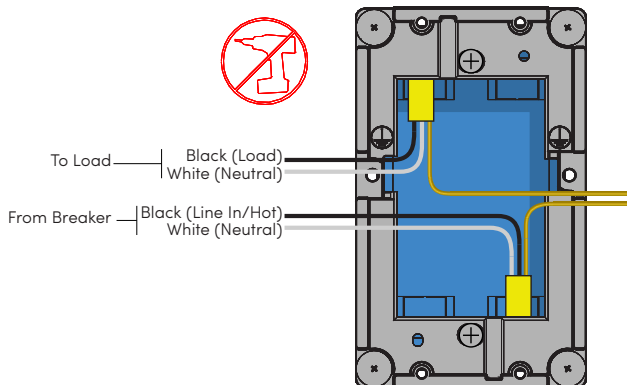

NOTE: When attaching multi-gang mounting plates, secure the mounting plate using 4 screws, one in each corner of the mounting plate. In rare cases, you may need to use the additional mounting plate screws to secure the middle of the mounting plate to the wall box to prevent it from bending outwards.

- 3 Connect the supplied ground wire lead to the ground wire in the wall box. Then, using the supplied hardware, fasten the ground wire lead to whichever side of the mounting plate that leaves the most space for the lighting device.

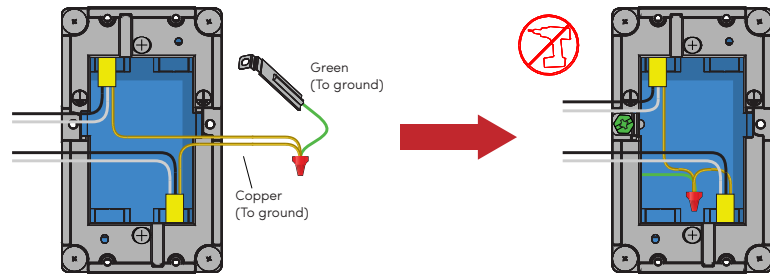

- 4 Install the Lux lighting device into the mounting plate. Refer to the Lux lighting device's install guide for details.
- 5 Orient the faceplate with the arrows pointing up. Align the faceplate to the mounting plate and guide it on until the four corner magnets snap it into place.

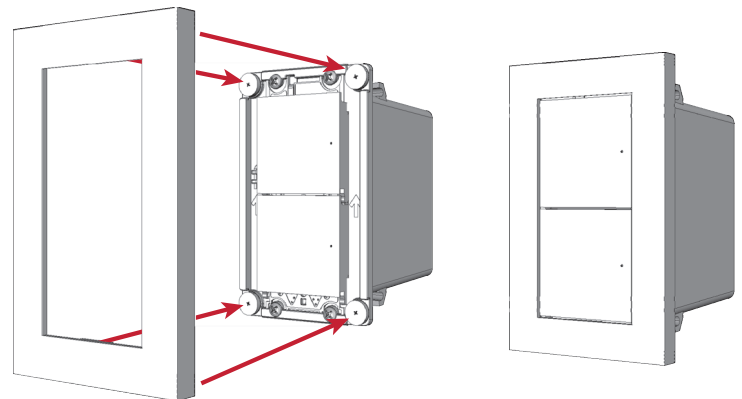

Removing the faceplate

- 1 Gently pull the faceplate until the magnets release.

Warranty and legal information

Find details of the product's Limited Warranty at snapone.com/legal or request a paper copy from Customer Service at 866.424.4489.

Find other legal resources, such as regulatory notices and patent information, at snapone.com/legal.

Control4[®]