

Control4[®] Lux Auxiliary Keypad Installation Guide

For the latest version of this guide and to view additional materials, open the URL below or scan the QR code. Your device must be able to view PDFs.

LATEST VERSION OF THIS GUIDE



CONTROL4 LUX QUICK START



CONTROL4 LUX WIRING GUIDE



Supported model

C4-L-KA Lux Auxiliary Keypad

Introduction

The Control4[®] Lux Auxiliary Keypad is intended for use in a Control4 system. It installs in standard and shallow US wall boxes. The Lux Auxiliary Keypad connects to other Control4 lighting devices capable of dimming or switching a load over the electrical wiring in the wall to provide keypad control of the load controlled by the other dimmer or switch.

Box contents

- Control4 Lux Auxiliary Keypad
- Warranty card
- Temporary button(s)
- Control4 Lux Auxiliary Keypad Installation Guide (this document)

Mounting plate required

The Control4 Lux Auxiliary Keypad **requires** a faceplate and mounting plate designed to fit your install (1 gang, 2 gang, etc) and are required before you install the keypad. Part numbers for faceplates and mounting plates:

- Lux Faceplate and Mounting Plate, 1 gang (C4-L-FP1-XX)
- Lux Faceplate and Mounting Plate, 2 gang (C4-L-FP2-XX)
- Lux Faceplate and Mounting Plate, 3 gang (C4-L-FP3-XX)
- Lux Faceplate and Mounting Plate, 4 gang (C4-L-FP4-XX)

Specifications

Model number	C4-L-KA-xx		
Power requirements	120/240V AC ±10% 50/60 Hz		
Environmental			
Operational temperature	0 to 40 °C (32 to 104 °F)		
Humidity	5% to 95% non-condensing		
Storage	-20 to 70 °C (-4 to 158 °F)		
Miscellaneous			
Wall box volume	77.84 ml (4.75 cubic inches)		
Weight	0.03 kg (0.07 lb.)		
Shipping weight	0.05 kg (0.12 lb.)		
Maximum supported keypads per load control device	10		
Maximum distance from load control device	45m (150ft) at 120 V AC, 30m (100ft) at 240 V AC		
Compatible color kit	C4-L-CKKA-XX		
Compatible devices			
C4-L-UDIM	Lux Universal Dimmer	C4-KD120	Keypad Dimmer
C4-L-KDS	Lux Keypad Dimmer Switch	C4-KD240	Keypad Dimmer
C4-L-SW	Lux Switch	C4-KD277	Keypad Dimmer
C4-L-TV	Lux 0-10V Dimmer	C4-SW120277	Switch
C4-APD120	Adaptive Phase Dimmer	C4-SW240	Switch
C4-APD240	Adaptive Phase Dimmer	C4-TV120277	0-10V Dimmer
C4-APD277	Adaptive Phase Dimmer	C4-TV240	0-10V Dimmer
C4-FPD120	Forward Phase Dimmer		

Warnings and considerations

Warning! Turn OFF electrical power before installing or servicing this product. Improper use or installation can cause SERIOUS INJURY, DEATH or LOSS/DAMAGE OF PROPERTY.

Attention ! Coupez l'alimentation électrique avant d'installer ou de réparer ce produit. Une mauvaise installation ou utilisation peut entraîner des blessures graves, décès ou perte / dommages à la propriété.

Warning! This device must be protected by a circuit breaker (20A max.).

Attention ! Cet appareil doit être protégé par un disjoncteur (20A max.).

Warning! Ground this device in accordance with the National Electric Code (NEC) requirements. DO NOT rely solely upon the mounting plate's contact with a metal wall box for adequate grounding. Use the device's ground wire to make a secure connection to the safety ground of the electrical system.

Attention ! Cet appareil doit être en conformité avec le Code national de l'électricité (NEC). Ne comptez pas uniquement au contact de la plaque avant avec un boîtier mural métallique pour la mise à la terre adéquate. Utilisez cet appareil à la terre de l'appareil pour établir une connexion sécurisée au système électrique.

Important! This device must be installed by a licensed electrician in accordance with all national and local electrical codes.

Important! If you are unsure about any part of these instructions, consult a qualified electrician.

Important! Use this device only with copper or copper-clad wire. Do not use aluminum wiring. This product has not been approved for use with aluminum wiring.

Important! Install in accordance with all applicable national and local electrical codes.

Important! Using this product in a manner other than outlined in this document voids your warranty. Further, Snap One is NOT liable for any damage incurred with the misuse of this product. See "Troubleshooting."

Important! Do NOT use a power screwdriver to install this device. If you do, you may overtighten the screws and strip them. Also, overtightening the screws may interfere with proper button operation.

Important! This is an electronic device with intricate components. Handle and install with care!

Important! The total length of wire connecting all Auxiliary Keypads to the switch or dimmer must not exceed 45 m (150 ft.) at 120V AC or 30 m (100 ft.) at 240V AC.

Installation instructions

1 Turn off the local electrical power by either switching off the circuit breaker or removing the fuse from the fuse box. To ensure the wires do NOT have power running to them, use an inductive voltage detector.

2 Prepare each wire. Wire insulation should be stripped back 1/2 of an inch (13 mm) from the wire end. You can use the strip gauge on the back of the keypad to check the proper length.

3 Identify your wiring application, and then see the appropriate wiring diagram in the *Sample Wiring Configurations* section below.

4 Using a *manual screwdriver*, install the mounting plate to the wall box. Do not overtighten the screws. Pull the rest of the wires through the mounting plate.

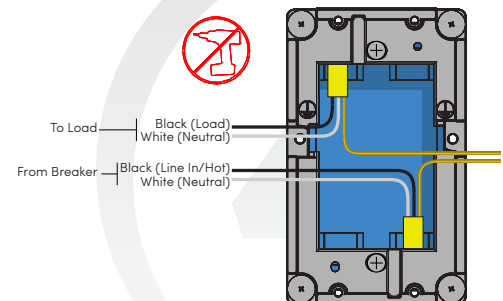
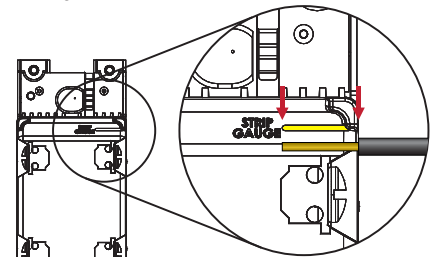

- 5 Connect the supplied ground wire lead to the ground wire in the wall box. Then, using the supplied hardware, fasten the ground wire lead to whichever side of the mounting plate that leaves the most space for the lighting device.

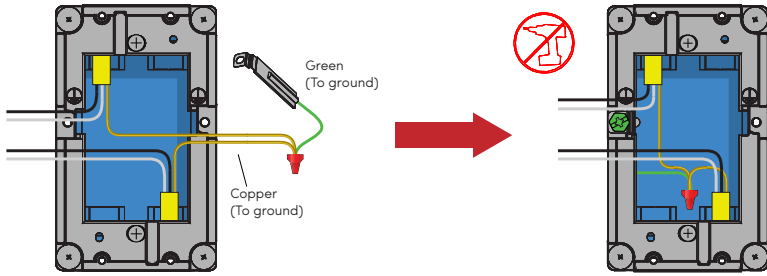

IMPORTANT! As described in the section *Warnings and Considerations*, DO NOT rely solely upon the mounting plate's contact with a metal wall box for adequate grounding.

- 6 Identify and connect the wires to the back of the keypad. Insert the wire into the terminal and tighten the terminal screw to 15 in-lb (1.7 Nm) of torque.



Note: You must use the same size and type of wire in each terminal for proper connection.

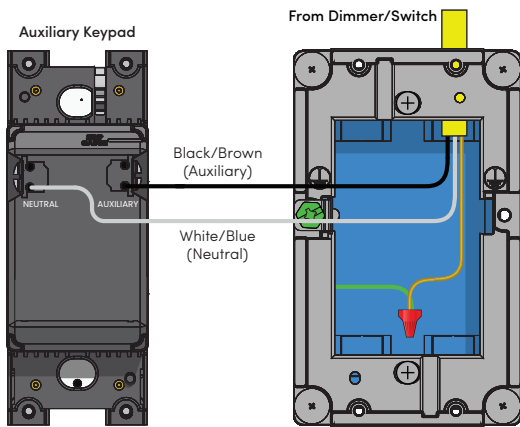

- 7 Fit the wires back into the wall box. Bend the wires in a zigzag pattern so that they easily fold into the wall box.

- 8 Insert the device into the mounting plate and fasten it with screws. Overtightening can warp the device, causing mechanical malfunction and difficulty mounting the buttons and faceplate.

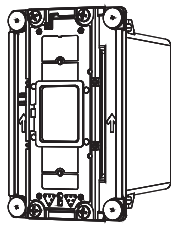

Caution: Install buttons after device is installed in the wall box. Pushing the device into the wall box with buttons installed may damage the device.

- 9 Install the temporary rocker onto the device. The back of the rocker has two arrows to indicate which end goes up. Line up the button's tabs to the device's pegs. Hold one side of the rocker in place over the device and snap the other side into place.

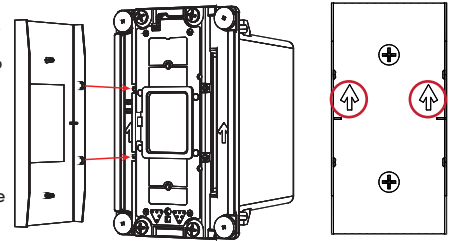

- 10 Install the Control4 faceplate following the instructions in the Control4 Lux Faceplate Installation Guide (ctrl4.co/lux-fp-ig).

- 11 Turn on power at the circuit breaker or replace the fuse from the fuse box.

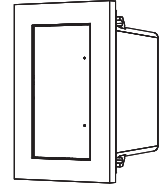

Troubleshooting

If the Auxiliary Keypad does not control the load that is connected to the associated dimmer, switch, or Fan Speed Controller:

- Ensure that the circuit breaker is not turned off or tripped.
- Check for proper wiring of both the Auxiliary Keypad and the associated dimmer or switch (see "Sample wiring configurations").

Care and cleaning

- Do **not** paint the keypad or its wall plate.
- Do **not** use any chemical cleaners to clean the keypad.
- Clean surface of the keypad with a soft damp cloth as needed.

Warranty and legal information

Find details of the product's Limited Warranty at snapone.com/legal or request a paper copy from Customer Service at 866.424.4489.

Find other legal resources, such as regulatory notices and patent information, at snapone.com/legal.

Copyright ©2024, Snap One, LLC. All rights reserved. Snap One and its respective logos are registered trademarks or trademarks of Wirepath Home Systems, LLC, dba "Control4" and/or dba "SnapAV" in the United States and/or other countries. Other names and brands may be claimed as the property of their respective owners. All specifications subject to change without notice.

200-00744-A.1 2024-12-16 MK

Sample Wiring Configuration

